

Features

- Modular check valves for blocking flow in one direction and allowing flow in the opposite direction. Pilot Operated checks permit the blocked flow to open when pressure is achieved in the pilot line.
- Modular design allows stacking of other modules to create custom circuits to improve the system design,
- Modular valves are flexible, easy to replace and maintain without the cost of custom manifolds.



VMCP



VMC

Ordering Details

V	Valve
M	Modular
C	Type: C = Check, CP = Pilot Operated Check
6-	Mounting Size: _____
P-	Circuit Function: _____
1	Series

Code	Size
6	NG6 (D03)
10	NG10 (D05)
16	NG16 (D07)
22	NG22/25 (D08)

Check, C		P.O. Check, CP	
Code	Symbol	Code	Symbol
P		A	
T		B	
B		AB	
A			

Example Part Number: VMC-6-P-1

Technical data

	Size	Max. Flow lpm (gpm)	Max. Pressure, bar (psi)	Check Valve Opening Pressure, Bar (psi)	Weight Kg (lbs.)	Fluid Recommendation	Working temperature
Check Valve	VMC-6	35 (9.2)	210 (3045)	0.35 (5)	1.1 (2.4)	Mineral Based, viscosity 2.8- 500mm ² /s	-20 to +80°C (-4 to +176°F)
	VMC-10	70 (18.4)	210 (3045)	0.35 (5)	2.5 (5.5)		
	VMC-16	300 (78.9)	250 (3625)	0.35 (5)	4.8 (10.56)		
	VMC-22	450 (118.4)	250 (3625)	0.35 (5)	10.5 (23.1)		
P.O. Check Valves	VMCP-6	50 (13.1)	315 (4568)	1.5 (21.75)	0.8 (1.76)		
	VMCP-10	80 (21.0)	315 (4568)	1.0 (14.5)	2 (4.4)		
	VMCP-16	200 (52.6)	315 (4568)	1.0 (14.5)	11.7 (25.74)		
	VMCP-22	300 (78.9)	315 (4568)	2.5 (36.25)	11.7 (25.74)		

Dimensional Data, VMC (Dimensions in mm)

VMC-6

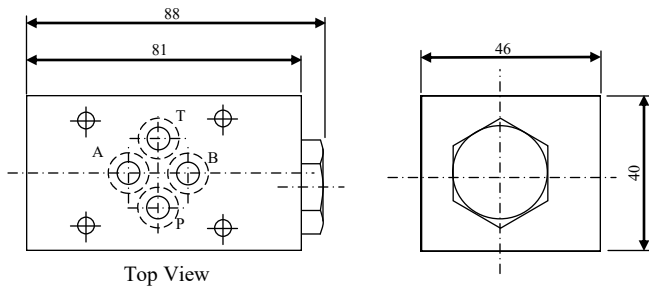

NG6/D03 Mounting Dimensions of mating surface

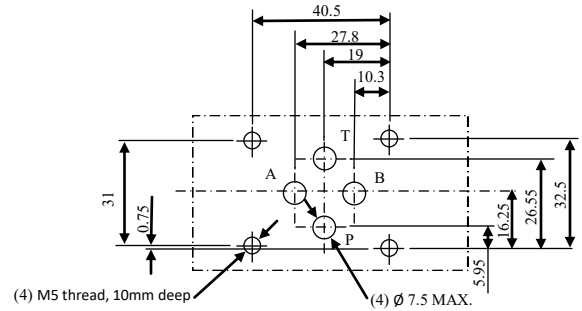

VMC-10-P/T

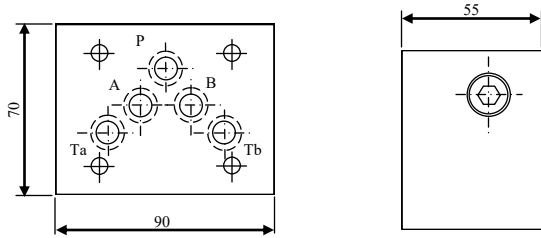

NG10/D05 Mounting Dimensions of mating surface

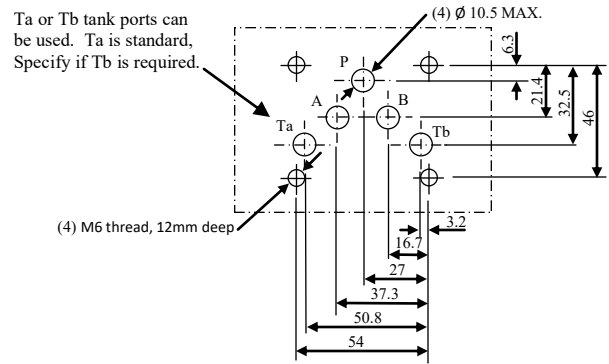

VMC-10-A/B

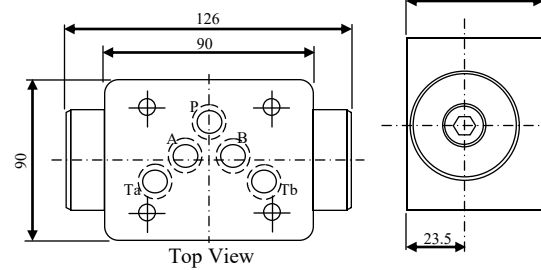

VMC-16-P/T

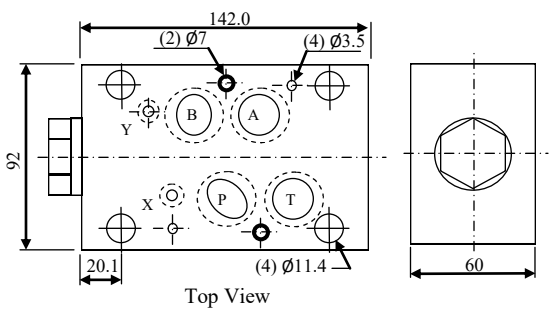

NG16/D07 Mounting Dimensions of mating surface

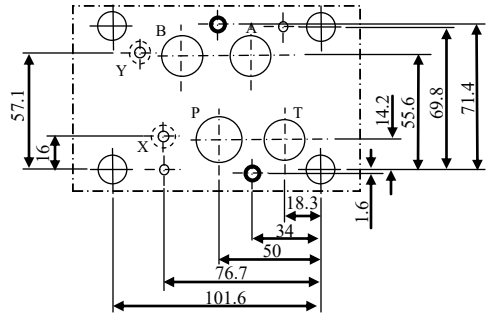

VMC-22-P/T

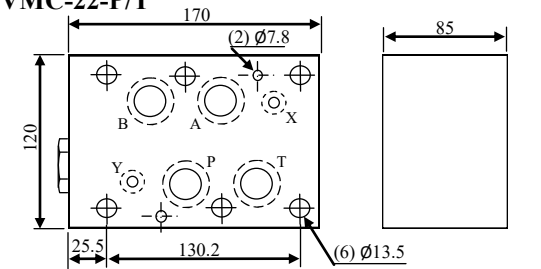

NG22/D08 Mounting Dimensions of mating surface

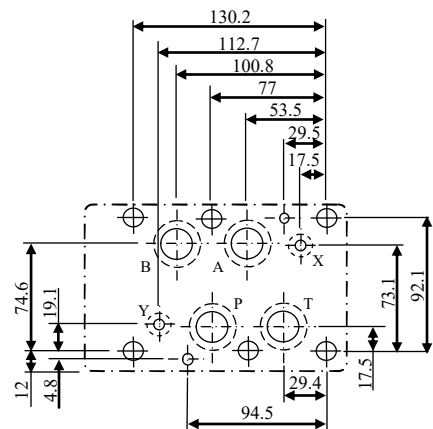

VMC-22-A/B

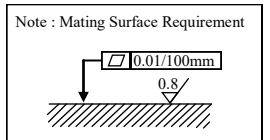
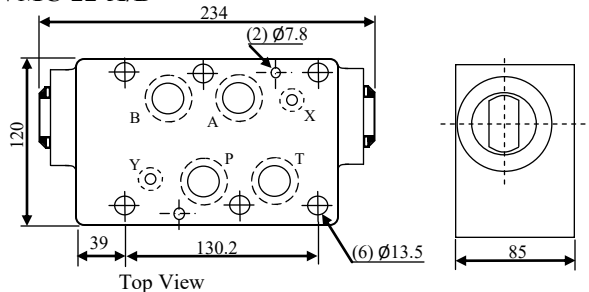

Dimensional Data, VMCP (Dimensions in mm)

VMCP-6

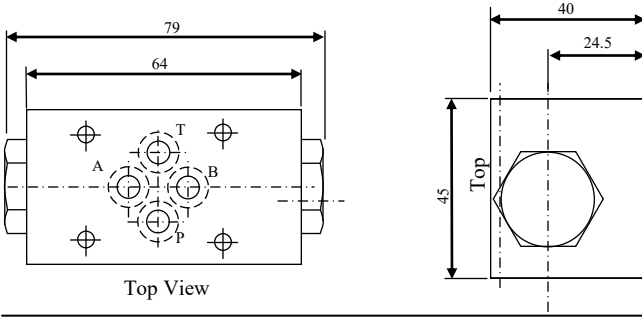

NG6/D03 Mounting Dimensions of mating surface

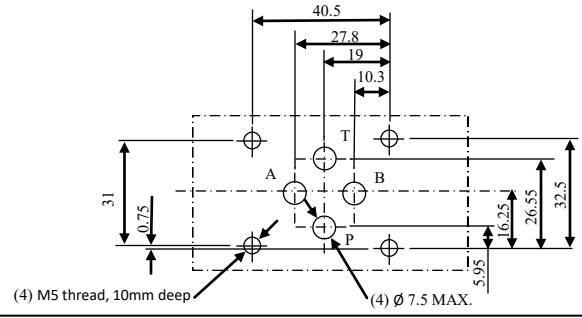

VMCP-10

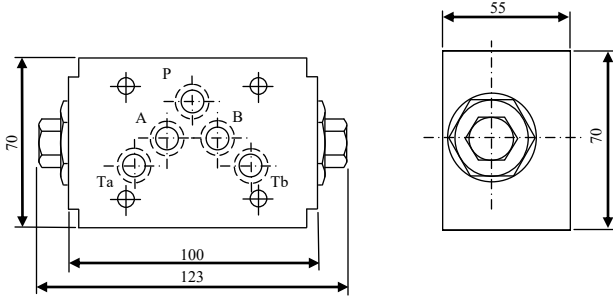

NG10/D05 Mounting Dimensions of mating surface

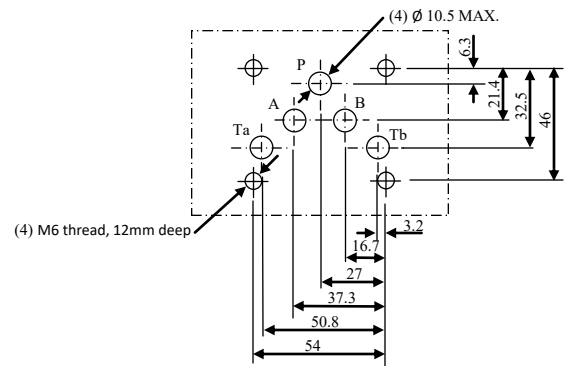

VMCP-16

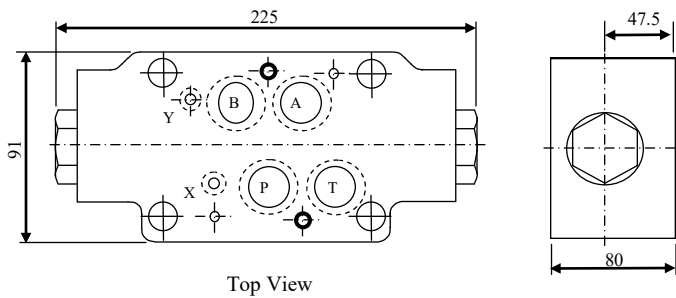

NG16/D07 Mounting Dimensions of mating surface

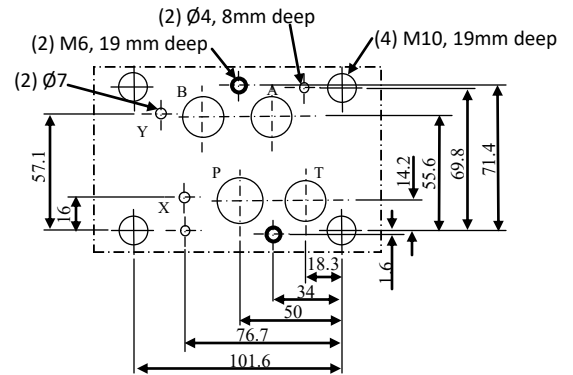

VMCP-22-A/B

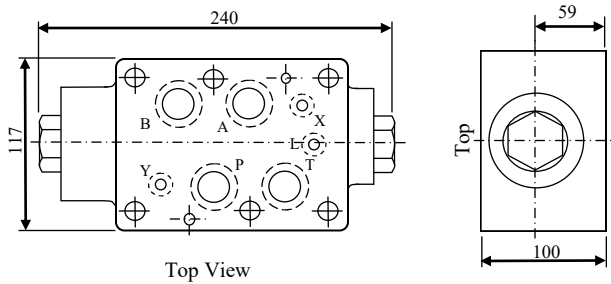

NG22/D08 Mounting Dimensions of mating surface

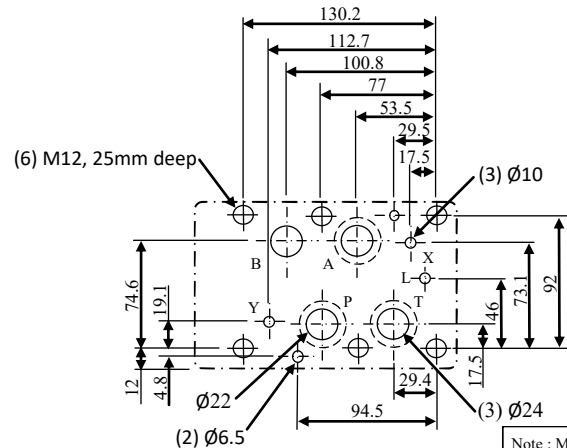

Note : Mating Surface Requirement